

# 1E93 Runner junior

## 1 1E93 Runner junior

The Runner is characterised by a durable and lightweight carbon spring providing the athletic child not only with a powerful drive, but with stable turning characteristics. Shifting the adapter alongside the carbon spring the dynamics and spring stiffness of the Runner are adaptable according to individual requirements. This has no effect on the basic alignment.

- Anterior positioning of the adapter for relaxed running and comfort due to an increased spring deflection. (see fig. 4)
- Posterior positioning of the adapter for powerful running due to an increased forward propulsion. (see fig. 5)

## 2 4R224 Runner junior Pyramid Adapter, rotatable

The adapter's pyramid is continuously rotatable facilitating the individual adjustment of the prosthesis. Altogether the adapter is lightweight and robust.

## 3 2Z543 Runner junior Sole

The Runner's all terrain, anti-skid sole allows the child to run in different terrains – from grass fields to tartan running tracks.

The Runner junior is suitable for active children up to approx. 13 years of age. Apart from allowing the child to take part in regular physical education at school, the Runner supports the child's development in terms of training and competing with their peers. Apart from its lightweight carbon construction the Runner junior features an appealing and catchy design.

The device's dynamics and spring stiffness can be adapted according to individual needs. Test fittings as well as final fitting solutions are easy to handle thanks to flexible adjustment options and the connectivity to the modular prosthetic system.

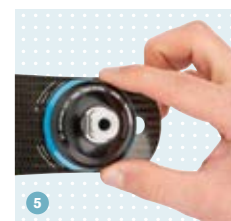
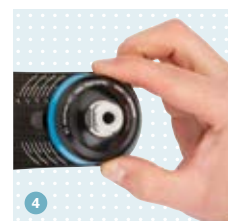

max. 45 kg / 99 lbs

### Stiffness chart

Body weight	Stiffness version
15 to 20 kg / 33 to 44 lbs	SPR-1
20 to 25 kg / 44 to 55 lbs	SPR-2
25 to 30 kg / 55 to 66 lbs	SPR-3
30 to 37 kg / 66 to 81 lbs	SPR-4
37 to 45 kg / 81 to 99 lbs	SPR-5

### Recommended solution

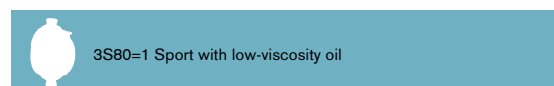

### Technical data

<b>Max. body weight</b>	45 kg / 99 lbs
<b>Weight</b>	170–210 g
<b>Recommended system components</b>	4R224 Runner junior Pyramid Adapter, rotatable 4R72 Double adapter, Titanium 2R58 Tube adapter long, Ø 34 mm 2R57 Tube adapter short, Ø 34 mm 4R82 Tube Clamp Adapter 4R116 Lamination anchor with pyramid adapter, rotatable 4R111 Lamination anchor with pyramid receiver, rotatable
<b>Accessory</b>	2Z543 Runner junior Sole

# Fax order form Runner junior sport prosthesis

Fax order to your Ottobock sales representative

Customer		Shipping address (if different from customer address)	
Customer no.	<input type="text"/>	Customer no.	<input type="text"/>
Company	<input type="text"/>	Company	<input type="text"/>
Street	<input type="text"/>	Street	<input type="text"/>
Postal code/city	<input type="text"/>	Postal code/city	<input type="text"/>
Phone number	<input type="text"/>	Phone number	<input type="text"/>
Orthotist	<input type="text"/>	Patient name	<input type="text"/>

## System overview (Please specify required order quantity.)

**1 4R111**  
Lamination Anchor with  
Pyramid Receiver,  
rotating  
**Quantity:** \_\_\_\_\_

**6 3S80=1 Sport**  
(max. 100 kg)  
Knee Joint  
**Quantity:** \_\_\_\_\_

**7 4R72\***  
Double Adapter  
Size:  
 32  45  60  75  
**Quantity:** \_\_\_\_\_

**10 4R224**  
Runner junior Pyramid  
Adapter, rotatable  
**Quantity:** \_\_\_\_\_

**11 1E93 Runner junior**  
Stiffnes version:  
 SPR-1  
 SPR-2  
 SPR-3  
 SPR-4  
 SPR-5  
**Quantity:** \_\_\_\_\_

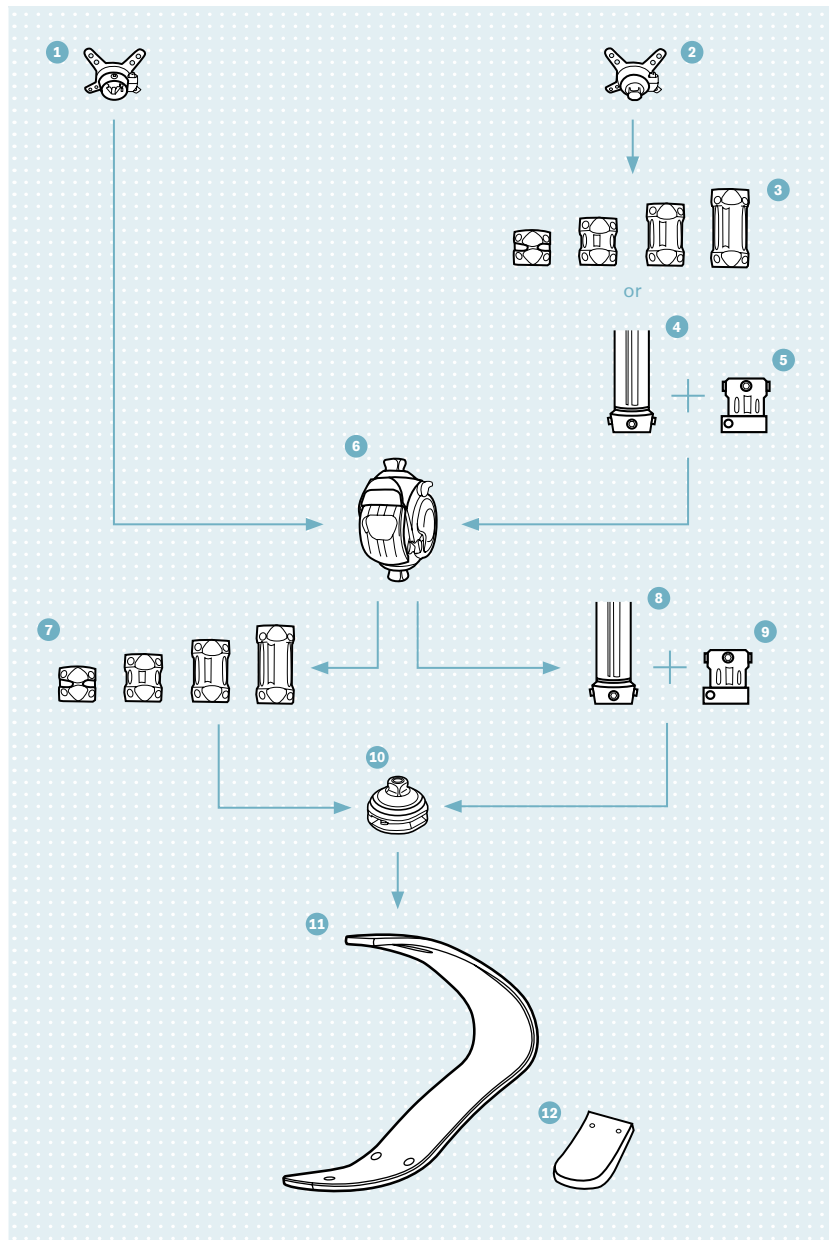

**2 4R116**  
Lamination Anchor with  
Pyramid Adapter,  
rotating  
**Quantity:** \_\_\_\_\_

**3 4R72\***  
Double Adapter  
Size:  
 32  45  60  75  
**Quantity:** \_\_\_\_\_

**4 2R58 (long)**  
Tube Adapter  
**Quantity:** \_\_\_\_\_  
or  
**2R57 (short)**  
Tube Adapter  
**Quantity:** \_\_\_\_\_

**5 4R82**  
Tube Clamp Adapter  
**Quantity:** \_\_\_\_\_

**8 2R58 (long)**  
Tube Adapter  
**Quantity:** \_\_\_\_\_  
or  
**2R57 (short)**  
Tube Adapter  
**Quantity:** \_\_\_\_\_

**9 4R82**  
Tube Clamp Adapter  
**Quantity:** \_\_\_\_\_

**12 2Z543**  
Runner junior Sole  
**Quantity:** \_\_\_\_\_

Date \_\_\_\_\_ Place \_\_\_\_\_ Signature \_\_\_\_\_